

Service Trolleys

Soaking Sink Trolley for Cutlery - 610 mm



361264 (SSTR06)

Soaking Sink Trolley for cutlery 610mm

Short Form Specification

Item No.

Constructed in 304 AISI stainless steel. Framework in mm25 tubing, completely welded. The basin can accommodate bulk cutlery or n.1 dishwashing basket mm500x500. Drain valve with twist handle. N. 4 swivelling castors, two with brakes, mm125 in diameter.

Main Features

- Framework in 25 mm tubing, completely welded.
- Basin to accommodate bulk cutlery or 1 dishwashing basket 500x500mm.
- Unit to have a drain valve with twist handle.
- 4 pivoting Ø 125 mm wheels, 2 of which with brakes, fitted with plastic bumpers

Construction

- Constructed entirely in 304 AISI stainless steel.

APPROVAL: _____



Electrolux
PROFESSIONAL

Service Trolleys Soaking Sink Trolley for Cutlery - 610 mm

Front

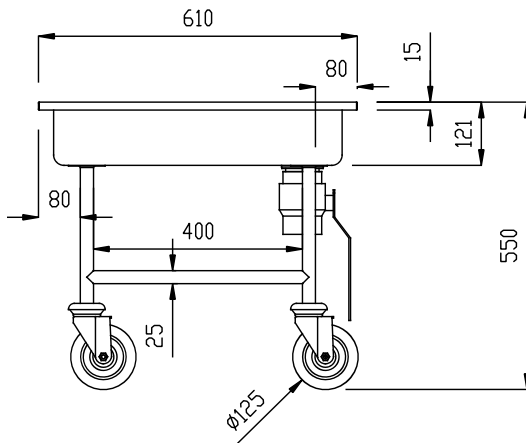

Side

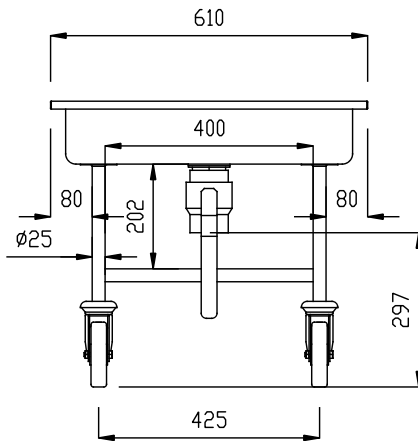

D = Drain

Top

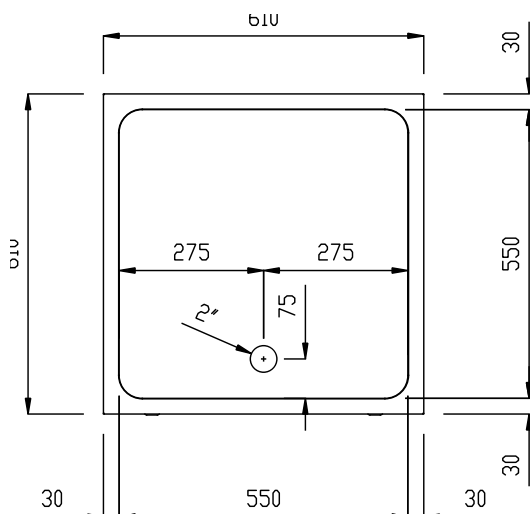

Key Information:

External dimensions, Width:	
361264 (SSTR06)	610 mm
External dimensions, Depth:	610 mm
External dimensions, Height:	550 mm
Wheel material:	Zinc plated
Wheel diameter:	Ø 125
Net weight:	20 kg

Service Trolleys
Soaking Sink Trolley for Cutlery - 610 mm

The company reserves the right to make modifications to the products without prior notice. All information correct at time of printing.

2022.05.04